



Shower Spectral Square

CIFIAL



Z-----



LOCATE THE FEEDER OUT FROM THE SHOWER IN THE SECURITY ZONE

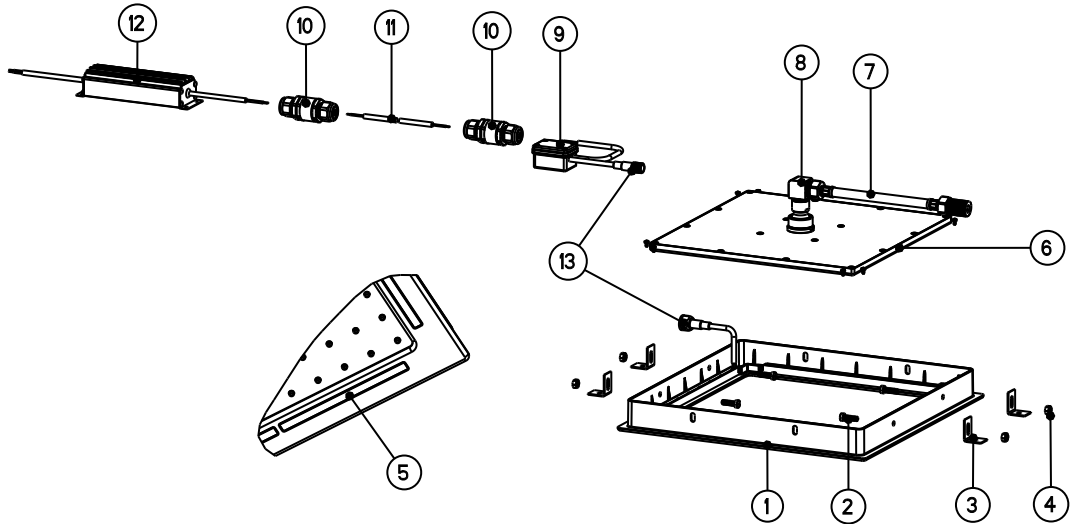

- 1 RAINBOW SWITCH SQUARE 300 FLANGE
- 2 SCREWS
- 3 ANCHORAGES
- 4 NUTS
- 5 LED 3.4V
- 6 HEADSHOWER 300 SQUARE
- 7 HOSE
- 8 BRASS CURVE
- 9 ELECTRONIC PCB
- 10 WIRE CONNECTION
- 11 CONNECTION IPX5
- 12 FEEDER Input: 100/240V 50/60Hz Output: 5VDC \pm 0.5V
- 13 CONNECTION IPX5
- 14 TEMPLATE
- 15 NIPPLES 1/2" GAS
- 16 NIPPLES 1/2" GAS - 1/2" NPT

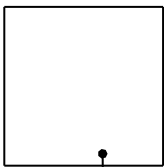

14

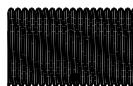

15

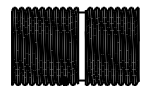

16

PHASE 1

GENERAL REQUIREMENT

DUCT FOR ELECTRIC CABLES

WATER CONNECTION

SWITCH
POWER
SUPPLY
(not included)

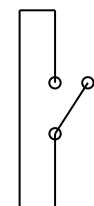
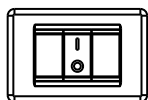

FEEDER LOCATION OUT
FROM THE SHOWER IN
THE SECURITY ZONE



THE INSTALLER MUST INSURE
THAT THE CEILING IS CAPABLE
OF BEARING THE WEIGHT OF
5 Kg INCLUDING WATER CONTENT

Max 17 mm

Max 43/64"

Min 200 mm

Min 8"



PHASE 2

Make hole with template
in the plaster board ceiling

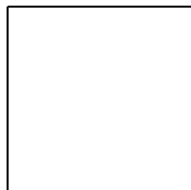
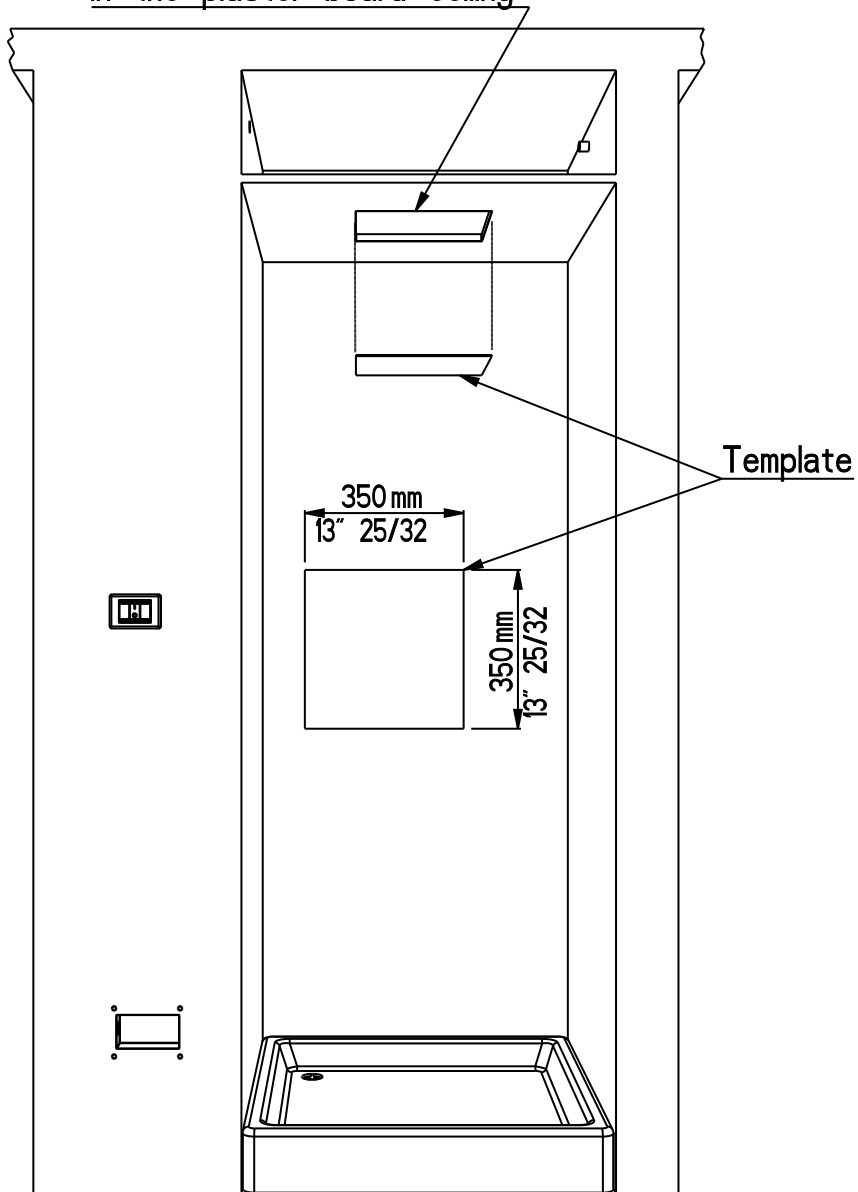

Template
Square 300

PHASE 3

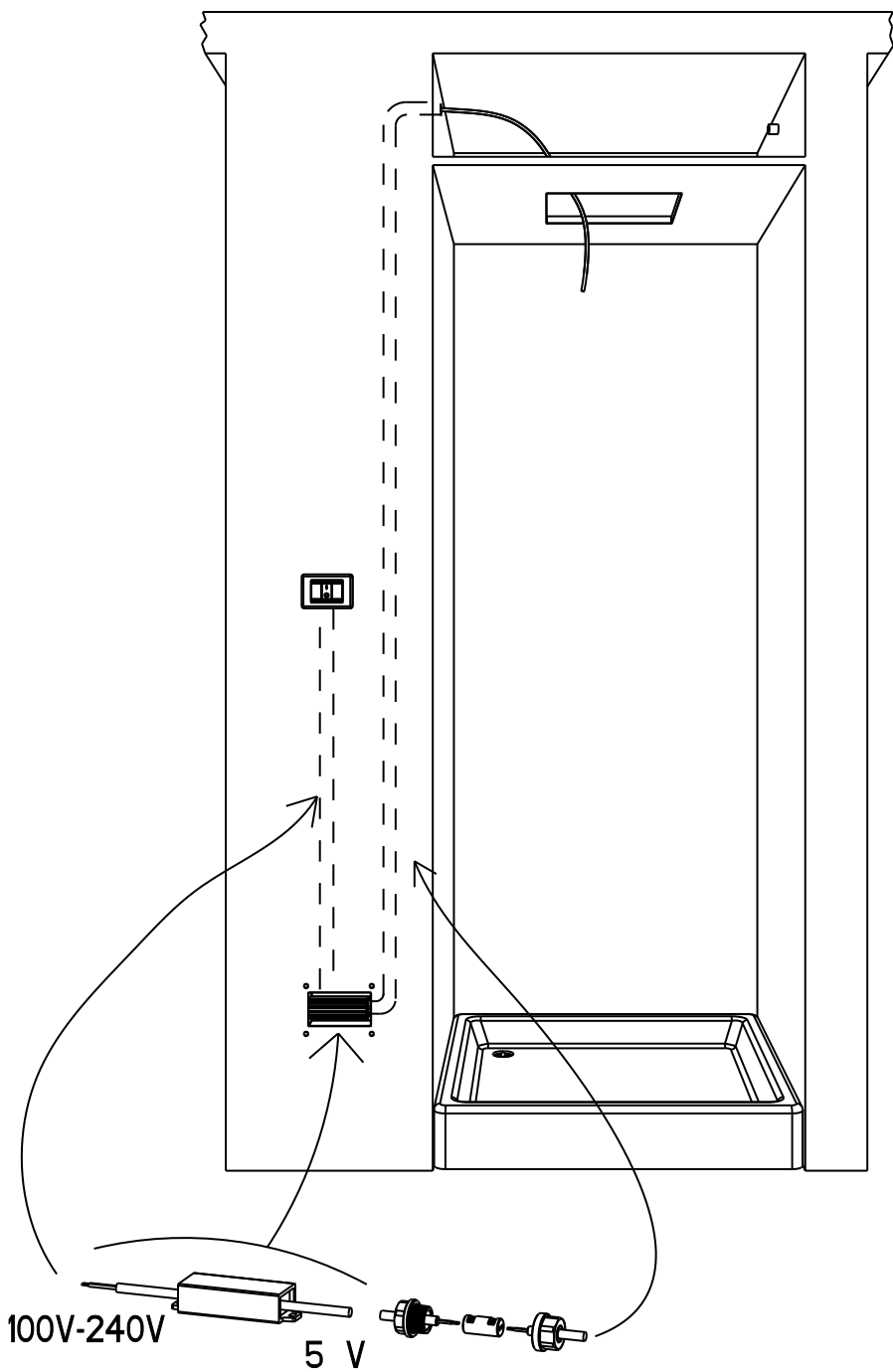

PHASE 4

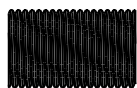
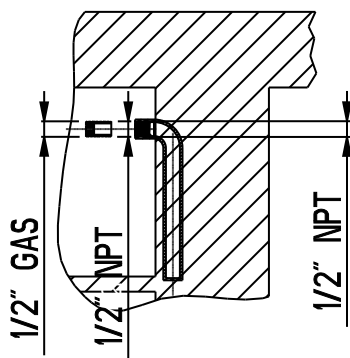
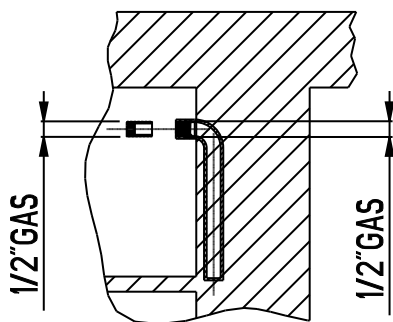
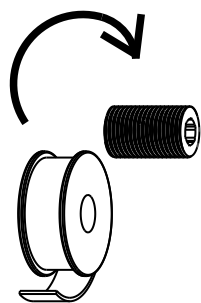
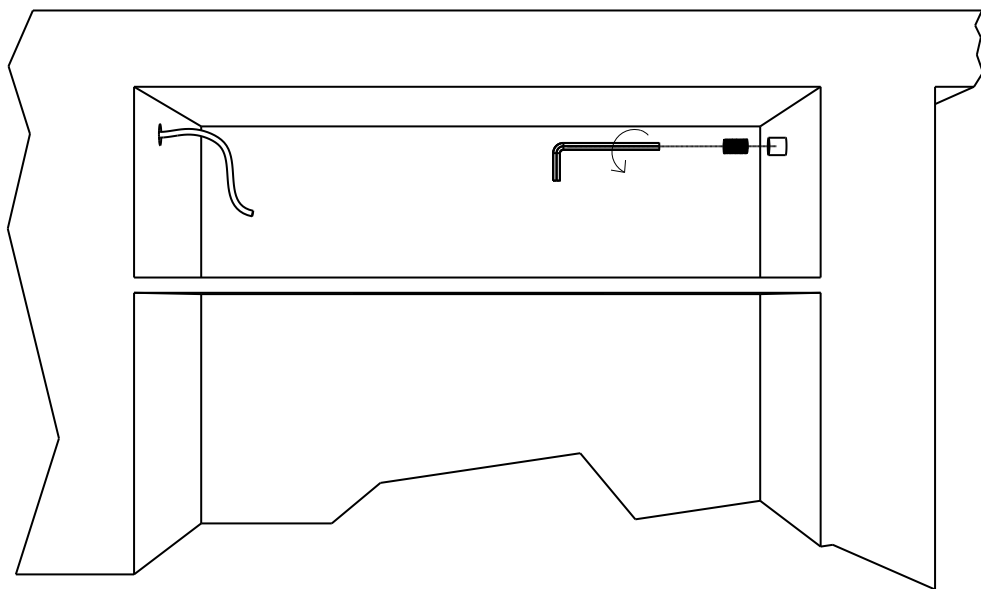

Nipples
1/2" Gas

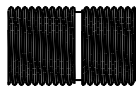

Nipples
1/2" Gas - 1/2" NPT

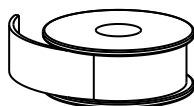

PTFE Tape

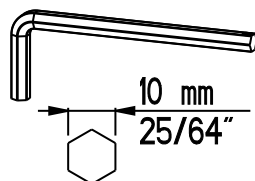

PHASE 5

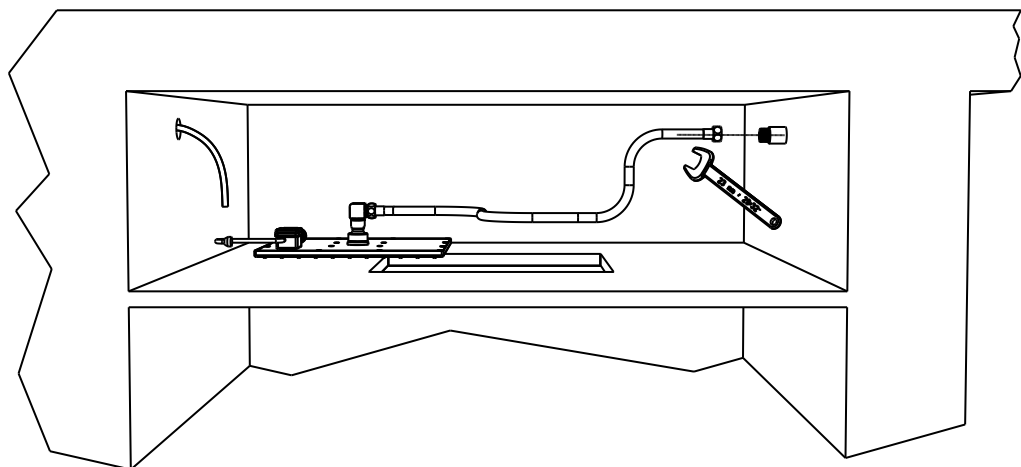

PHASE 6

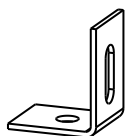
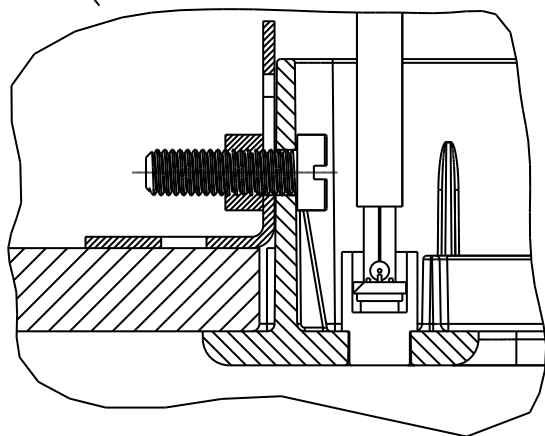
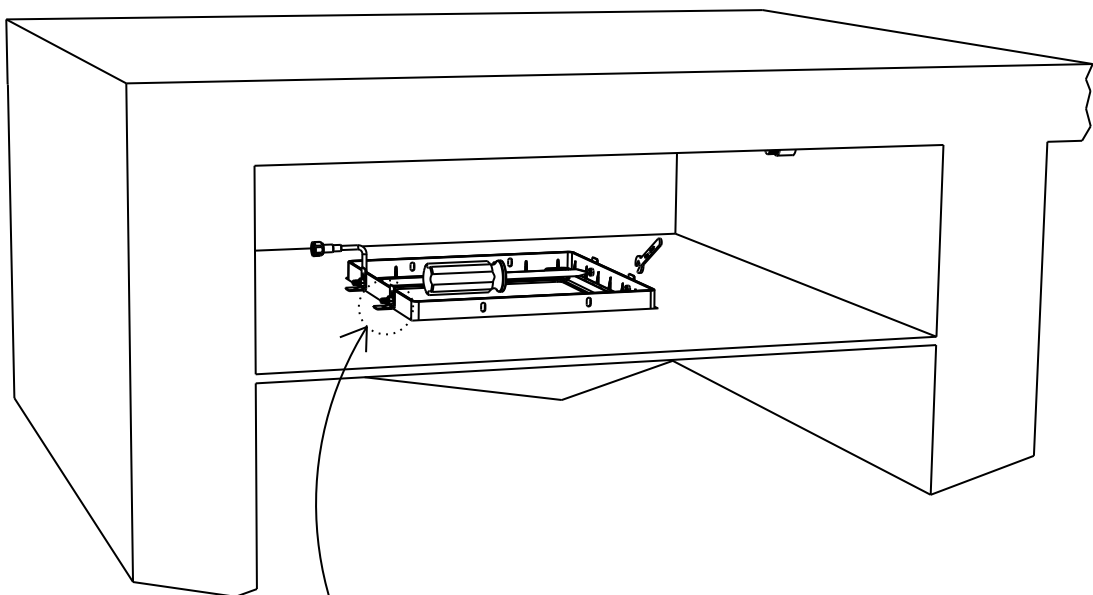

N° 4



N° 4



N° 4

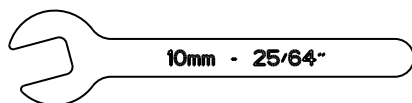
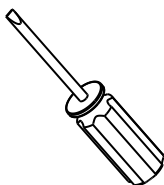

10mm - 25/64"

PHASE 7

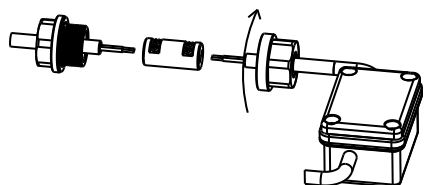
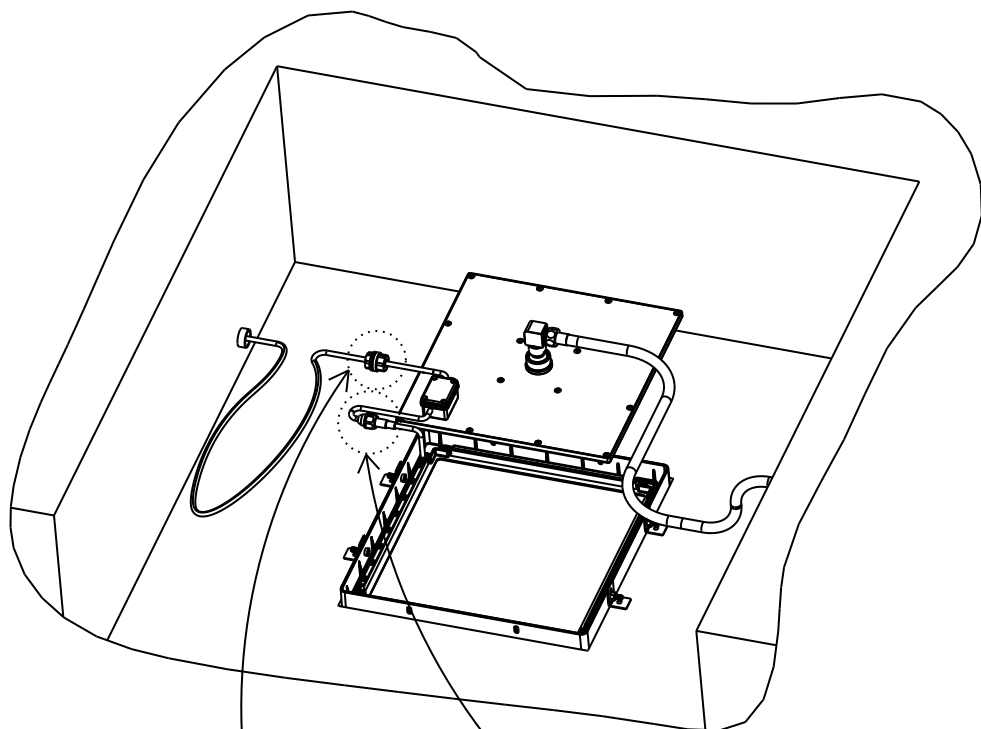

PCB CONNECTION

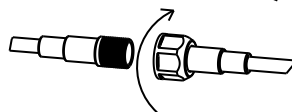

LED CONNECTION

PHASE 8

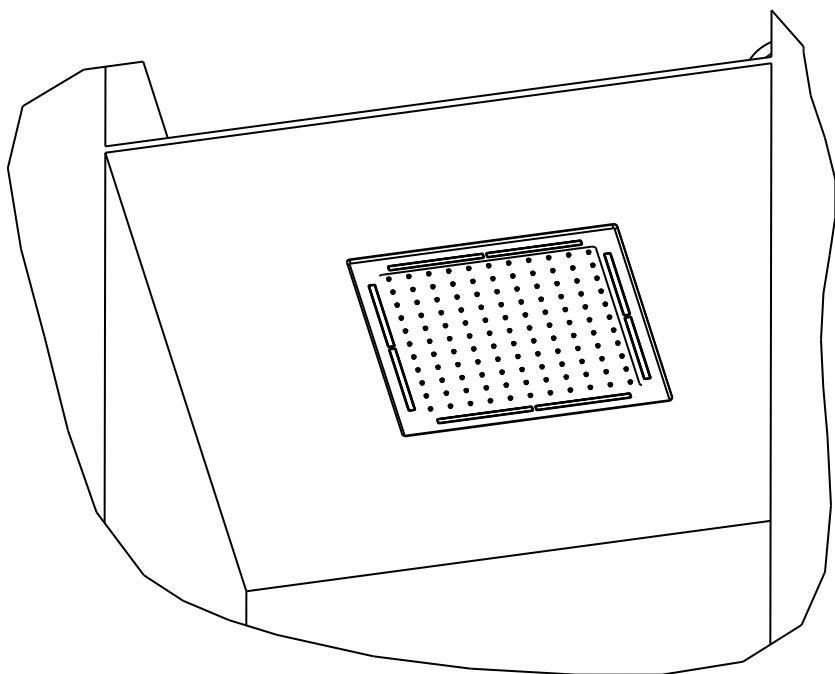
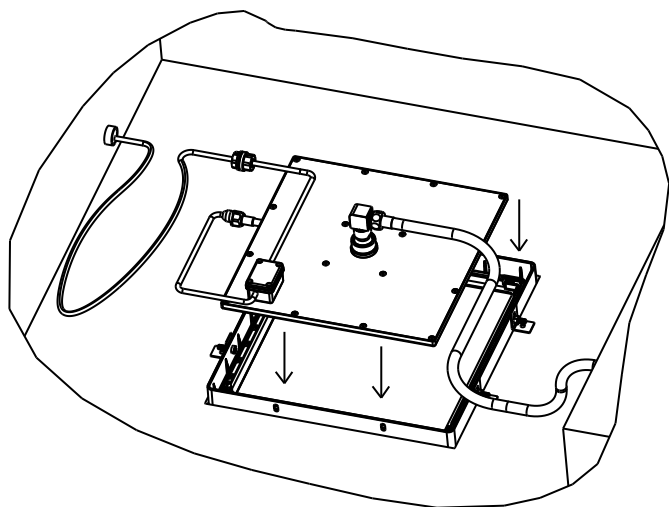

SHOWER SPECTRAL SQUARE

ELECTRIC SYSTEM - TECHNICAL DATA

- 1 ELECTRIC CONNECTION 100/240V - 50/60 Hz
- 2 PROTECTION CLASS II
- 3 n. 32 LED LOW VOLTAGE 3.4V ±
- 4 FEEDER Input 100-240V 50/60 Hz - Output 5VDC ± 0.5V / SELV
(locate the feeder in the security zone following CEI standard 64/8)
- 5 INDEX PROTECTION IPX5
- 6 MARKING APPROVAL CE

WARNING:

- 1: Insure the children and the deformity in care of the use and exposure to products
- 2: If need to teardown or service the product, please check with the professional or the manufacturers
- 3: Power lead manufacturers to provide or use the same specification of the power cord
- 4: Please read specification before use, according to specification requirements to operate the product and retain the specification
- 5: the producer doesn't answer for damages to things and/or persons, in case of wrong installation or changes to the original product, from the user

The electric fittings, must be performed from technical qualified,
in conformity to the national and international current laws in object

SHOWER SPECTRAL SQUARE

INDEX

Bill of Material.....	Pag. 1
Assemblage Phases.....	Pag. 2 - 9
Technical Data.....	Pag. 10